**CS6P****220/225/230/235/240/245/250M**

### Key Features

- 6 years product warranty (materials and workmanship); 25 years module power output warranty
- Industry leading plus only power tolerance: +5W (+2%)
- Strong framed module, passing mechanical load test of 5400Pa to withstand heavier snow load
- The 1st manufacturer in the PV industry certified for ISO:TS16949 (The automotive quality management system) in module production since 2003
- ISO17025 qualified manufacturer owned testing lab, fully complying to IEC, TUV, UL testing standards

### On-grid Module

CS6P is a robust solar module with 60 solar cells. These modules can be used for on-grid solar applications. Our meticulous design and production techniques ensure a high-yield, long-term performance for every module produced. Our rigorous quality control and in-house testing facilities guarantee Canadian Solar's modules meet the highest quality standards possible.

### Applications

- On-grid residential roof-tops
- On-grid commercial/industrial roof-tops
- Solar power stations
- Other on-grid applications

### Quality Certificates

- IEC 61215, IEC 61730, UL 1703, CE
- ISO9001: 2008: Standards for quality management systems
- ISO/TS16949:2009: The automotive quality management system
- QC080000 HSPM: The Certification for Hazardous Substances Regulations



# CS6P-220/225/230/235/240/245/250M

## Electrical Data

	CS6P-220M	CS6P-225M	CS6P-230M	CS6P-235M	CS6P-240M	CS6P-245M	CS6P-250M
Nominal Maximum Power at STC (Pmax)	220W	225W	230W	235W	240W	245W	250W
Optimum Operating Voltage (Vmp)	29.5V	29.7V	29.9V	30.1V	30.2V	30.3V	30.4V
Optimum Operating Current (Imp)	7.45A	7.58A	7.70A	7.82A	7.95A	8.09A	8.22A
Open Circuit Voltage (Voc)	36.9V	37.0V	37.1V	37.2V	37.3V	37.4V	37.5V
Short Circuit Current (Isc)	7.97A	8.07A	8.22A	8.34A	8.46A	8.61A	8.74A
Operating Temperature	-40°C~+85°C						
Maximum System Voltage	1,000V (IEC) /600V (UL)						
Maximum Series Fuse Rating	15A						
Power Tolerance	+5W						
Temperature Coefficient	Pmax	-0.45%/°C					
	Voc	-0.35%/°C					
	Isc	0.060%/°C					
	NOCT	45°C					

Under Standard Test Conditions (STC) of irradiance of 1000W/m<sup>2</sup>, spectrum AM 1.5 and cell temperature of 25°C

## Mechanical Data

Cell Type	Mono-crystalline
Cell Arrangement	60 (6 x 10)
Dimensions	1638 x 982 x 40mm (64.5 x 38.7 x 1.57in)
Weight	20kg (44.1 lbs)
Front Cover	Tempered glass
Frame Material	Anodized aluminium alloy
Standard Packaging (Modules per Pallet)	20pcs

## Engineering Drawings

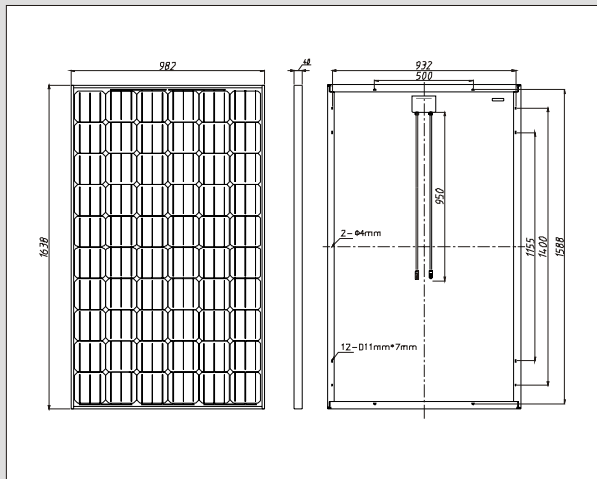

\*Specifications included in this datasheet are subject to change without prior notice.

## I-V Curves (CS6P-250M)

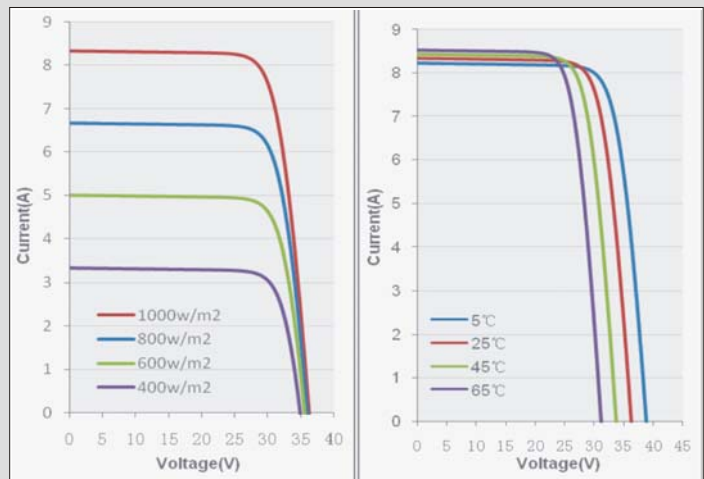

EN-Rev 3.31 Copyright © 2010 Canadian Solar Inc.

## About Canadian Solar

Canadian Solar Inc. is one of the world's largest solar companies. As a leading vertically-integrated manufacturer of ingots, wafers, cells, solar modules and solar systems. Canadian Solar delivers solar power products of uncompromising quality to worldwide customers. Canadian Solar's world class team of professionals works closely with our customers to provide them with solutions for all their solar needs.

Canadian Solar was founded in Canada in 2001 and was successfully listed on NASDAQ Exchange (symbol: CSIQ) in November 2006. Canadian Solar is on track to expand cell capacity to 700MW and module capacity to 1.3GW in 2010.

Headquarters | 650 Riverbend Drive, Suite B Kitchener, Ontario  
Canada N2K 3S2 | Tel: +1-519-954-2057 | Fax: +1-519-578-2097  
inquire.ca@canadiansolar.com

European Office | Canadian Solar Deutschland GmbH |  
Landsberger Strasse 94 | 80339 Munich | Germany  
Tel: +49 (0) 89 - 51 996 89 - 0 | Fax: +49 (0) 89 - 51 996 89 - 11  
inquire.eu@canadiansolar.com